



AudiaEXPI-D is a digital input expander for Audia®, the benchmark in digital audio systems for demanding professional sound installations. AudiaEXPI-D accepts eight channels of digital audio input and provides eight channels of digital audio output via CobraNet®. AudiaEXPI-D can simply add inputs to a centralized system, or it can extend system boundaries by providing inputs in remote locations. AudiaEXPI-D is represented as a block in Audia software, for easy inclusion into any system design. AudiaEXPI-D may also be used to provide inputs to other CobraNet compliant systems or devices.

FEATURES

- 4 AES3 digital audio inputs on XLR (xfmr coupled)
- 2 SPDIF inputs (selectable channels 1-2 & 3-4)
- 2 TOSLINK inputs (selectable channels 5-6 & 7-8)
- 8 channels of digital audio output via CobraNet
- Word Clock output on BNC connector
- rotary encoder with LCD for programming/setup
- logic inputs for recalling preset configurations
- included as block in AUDIA system design software
- may be used with any CobraNet compliant system
- **RoHS** compliance and **AES** grounding practices
- **CE** marked and **UL** listed power source
- covered by Biamp Systems' five-year warranty

ARCHITECTS & ENGINEERS SPECIFICATION

The Digital Input Expander shall provide four pairs of AES3 transformer coupled digital audio inputs on XLR connectors. Two of these pairs shall be selectable instead as SPDIF inputs on RCA connectors and the other two pairs shall be selectable instead as TOSLINK inputs. Eight channels of digital audio output shall be provided via CobraNet®, on two rear panel RJ45 connectors. A word clock output shall be provided on BNC connector. A rotary encoder and LCD screen shall be provided on the front panel for programming and setup. Logic Inputs shall be provided for recalling preset configurations.

The Digital Input Expander shall be represented as a functional block within Audia® software, for easy inclusion into system designs. The Digital Input Expander shall also be capable of providing digital audio inputs to other CobraNet compliant systems or devices. The Digital Input Expander shall be CE marked with a UL / C-UL listed power source, and shall incorporate AES48-2005 Grounding & EMC practices. The Digital Input Expander shall be compliant with EU Directive 2002/95/EC, the RoHS directive. Warranty shall be 5 years.

The Digital Input Expander shall be AudiaEXPI-D.

AudiaEXPI-D SPECIFICATIONS

Sample Rate: 48kHz CobraNet network 96kHz CobraNet network Bit Resolution (determined by input source or CobraNet): up to 24 bits Audio Input Signal Characteristics / Connectors: AES3 compliant, transformer coupled XLR SPDIF compliant RCA TOSLINK compliant Optical Clock Output Signal Characteristics / Connector: single ended, TTL compatible BNC Logic Input Characteristics: TTL or contact-closure	CobraNet I/O: 100Mb ethernet Power Consumption (115/230VAC 50/60Hz): < 12 watts Dimensions: height 1.75 inches (44.5mm) width 19 inches (483mm) depth 5.75 inches (146mm) Weight: 4.3 lbs. (2kg) Compliance: AES48-2005 Grounding & EMC practices EU Directive 2002/95/EC, RoHS directive CE marked UL listed power source
---	---

AudiaEXPI-D REAR PANEL DIAGRAM

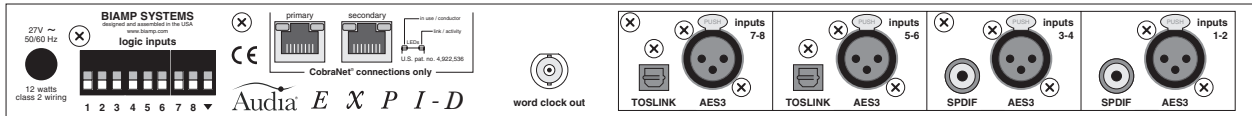

AudiaEXPI-D BLOCK DIAGRAM

